

## wiper A07-SA

## seal spec

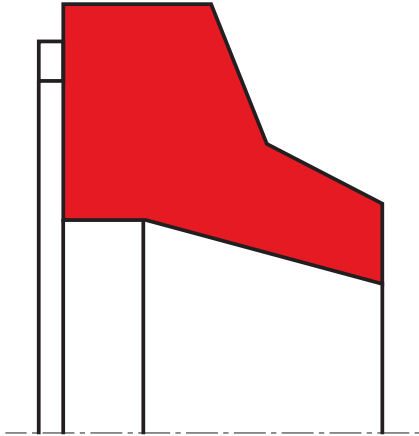

### description

wiper to fit in angled housings (30° angle).

### application



not bolded symbols; please consult our technical for application limitations

### category of profile

machined or molded/standard/trade product.

### single acting

### operating parameters & material

material	temperature	max. surface speed
s-mart NBR 90	-40°C ... + 100°C	≤ 2.0 m/s

the stated operation conditions represent general indications. it is recommended not to use all maximum values simultaneously. surface speed limits apply only to the presence of adequate lubrication film.

### surface quality

surface roughness	Rtmax (µm)	Ra (µm)
sliding surface	according to seal data	
bottom of groove	≤ 6,3	≤ 2.5
groove face	≤ 15	≤ 4.0

### tolerance recommendation

seal housing tolerances	
ØD	H10
ØD1	H11

### fitting & installation

the prerequisites for perfect functioning are careful fitting and an accurately dimensioned mounting space. in general, wipers snap easily into their mountings when distorted into a kidney shape (over 20mm diameter).

**seal & housing recommendations**

*please note that we are able to produce those profiles to your specific need or any non standard housing. for detail measurements, please see seal-mart catalog...*

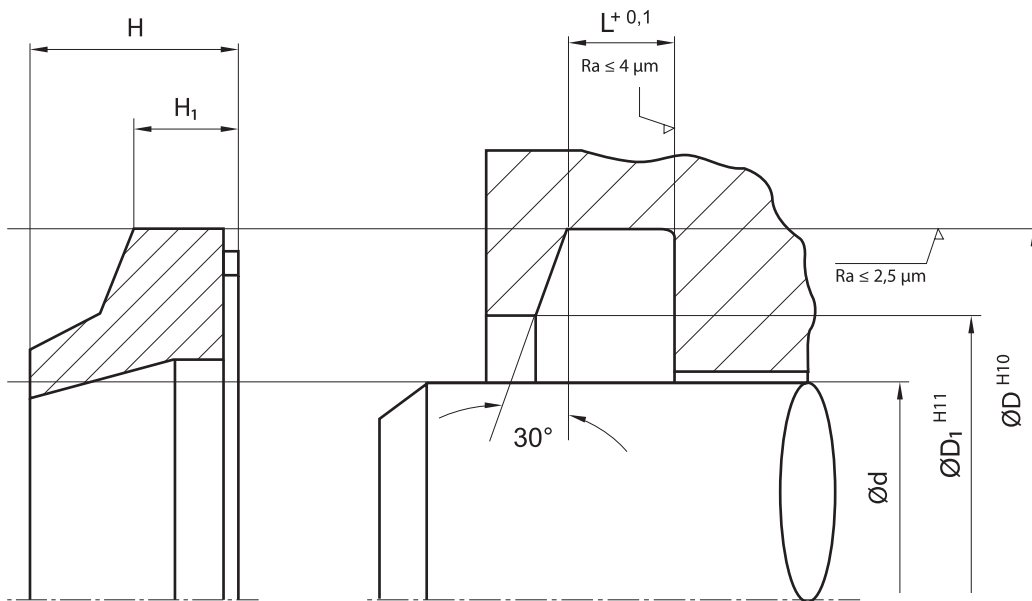

*don't hesitate to contact our technical department for further information or for special requirements (temperature, speed etc.), so that suitable materials and/or designs can be recommended.*